

THIS DRAWING IS UNPUBLISHED. RELEASED FOR PUBLICATION AUG ,2006.

© COPYRIGHT BY TYCO ELECTRONICS CORPORATION. ALL RIGHTS RESERVED.

LOC	DIST	REVISIONS					
DW		P	LTR	DESCRIPTION	DATE	DWN	APVD
		C1		REVISED (ECR-08-024595)	30SEP08	SC	WK

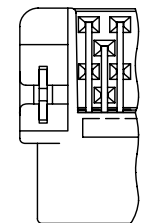

FOR 50 AND 130 POSITIONS ONLY

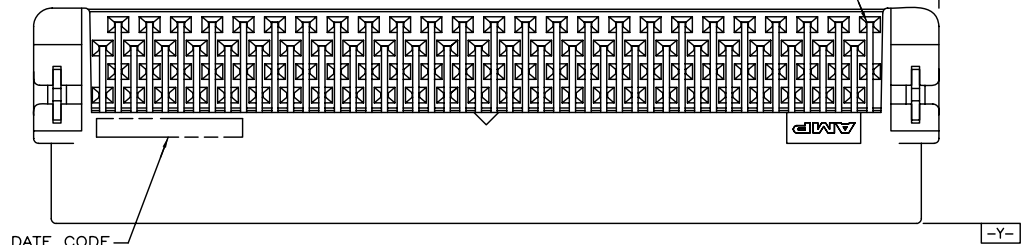

FOR 40, 60, 68, 80, 100, 120, 140, 160, 180 AND 200 POSITIONS ONLY

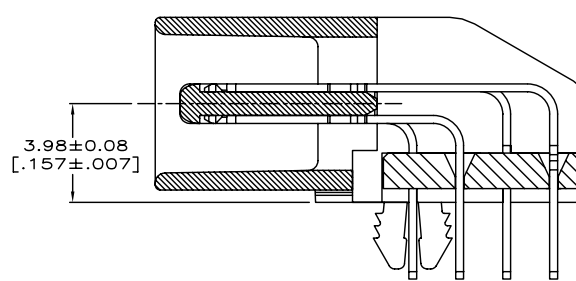

SECTION D-D  
SCALE 8:1

- △ HOUSING & TINE PLATE - LIQUID CRYSTAL POLYMER (LCP), UL 94V-0, BLACK.
- 2. CONNECTOR SOLDER TAILS WILL ACCOMMODATE PRINTED CIRCUIT BOARD THICKNESS OF 0.8 TO 1.6 [.031 TO .063].
- △ G, J, H INDICATE NUMBER OF POSITION MARKED ON ASSEMBLY. ALSO SEE TABLE.
- 4. CONTACTS- PHOSPHOR BRONZE PLATED WITH MINIMUM THICK (SEE TABLE) GOLD IN CONTACT AREA AND 3.81μm [.000150] MINIMUM THICK MATTE TIN ON SOLDER TINES OVER 1.27μm [.000050] MINIMUM THICK NICKEL UNDERPLATE.
- 5. RETENTION LEG- BRASS PLATED WITH 3.81μm [.000150] MINIMUM TIN-Cu OVER 1.27μm [.000050] MINIMUM NICKEL UNDERPLATE.
- 6. ALWAYS RoHS/ELV COMPLIANT.
- 7. WAVE SOLDER CAPABLE TO 265°C PER TE SPEC 109-202, CONDITION B.

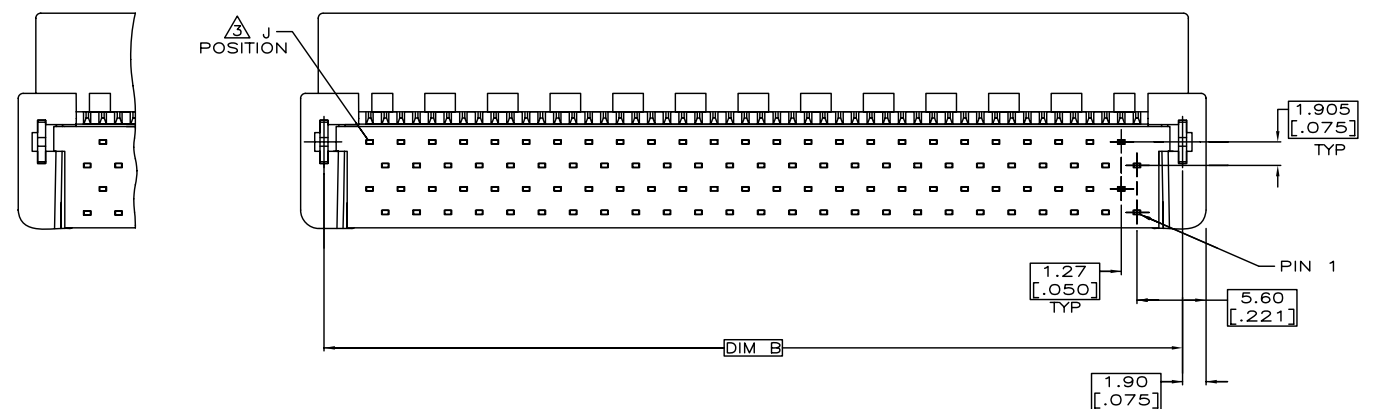
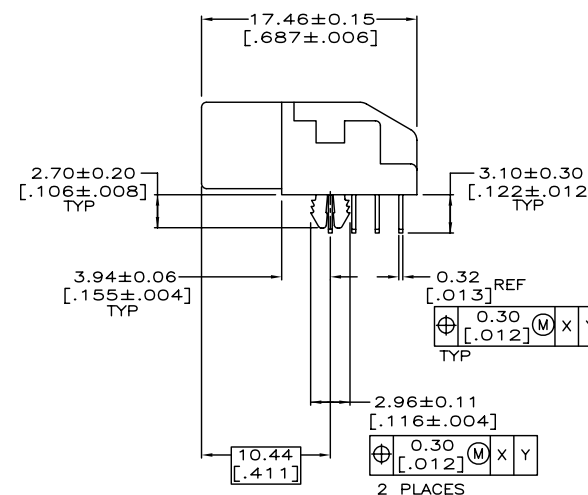
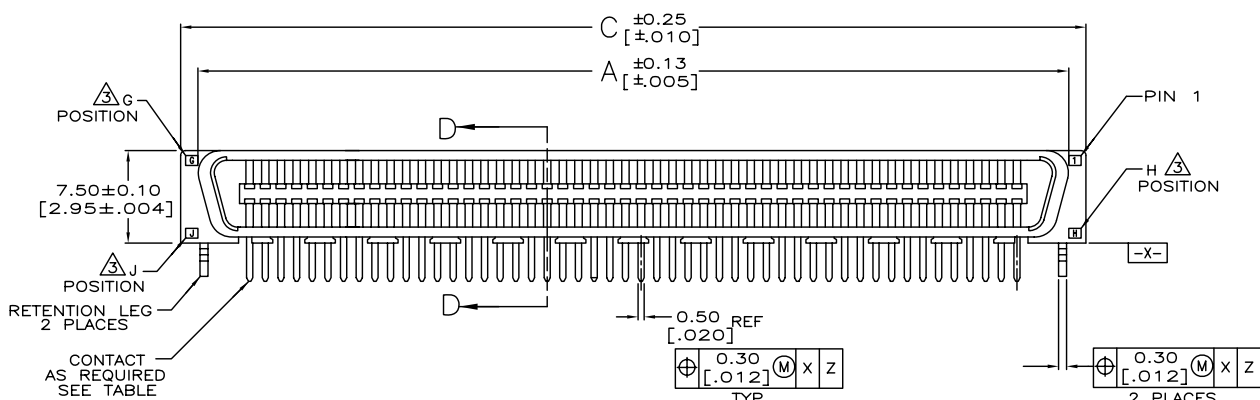

C	B	A	G	J	H	A	GOLD	PART NUMBER
136.93 [5.891]	133.13 [5.241]	134.07 [5.278]	100	200	101	0.00076 [.000030]	1-1734099-8	
111.53 [4.391]	107.73 [4.241]	108.67 [4.278]	80	160	81	0.00076 [.000030]	1-1734099-6	
98.83 [3.891]	95.03 [3.741]	95.97 [3.778]	70	140	71	0.00076 [.000030]	1-1734099-4	
86.13 [3.391]	82.33 [3.241]	83.27 [3.278]	20	120	61	0.00076 [.000030]	1-1734099-2	
73.43 [2.891]	69.63 [2.741]	70.57 [2.778]	50	100	51	0.00076 [.000030]	1-1734099-0	
60.73 [2.391]	56.93 [2.241]	57.87 [2.278]	40	80	41	0.00076 [.000030]	1734099-8	
53.11 [2.091]	49.31 [1.941]	50.25 [1.978]	34	68	35	0.00076 [.000030]	1734099-7	
48.03 [1.891]	44.23 [1.741]	45.17 [1.778]	30	60	31	0.00076 [.000030]	1734099-6	
41.68 [1.641]	37.88 [1.491]	38.82 [1.528]	25	50	26	0.00076 [.000030]	1734099-5	
35.33 [1.391]	31.53 [1.241]	32.47 [1.278]	20	40	21	0.00076 [.000030]	1734099-4	

THIS DRAWING IS A CONTROLLED DOCUMENT.

DWN S. CHIEN 30SEP2008  
CHK S. CHIEN 30SEP2008  
APVD W. KODAMA 30SEP2008

Tyco Electronics Corporation  
Tyco Electronics  
Taipei, Taiwan

NAME: PLUG ASSEMBLY, RIGHT ANGLE, 13.2 mm, BOARD-TO-BOARD, CHAMP .050, SERIES I

PRODUCT SPEC: 108-1367

QUALIFICATION TEST REPORT

SIZE: A3 CAGE CODE: 00779 DRAWING NO: C-1734099 RESTRICTED TO: -

WEIGHT: - GRAMS

CUSTOMER DRAWING

SCALE: - SHEET: 1 OF 4 REV: C1

THIS DRAWING IS UNPUBLISHED.

RELEASED FOR PUBLICATION

AUG ,2006.

© COPYRIGHT BY TYCO ELECTRONICS CORPORATION. ALL RIGHTS RESERVED.

LOC

DIST

REVISIONS

DW

P

LTR

DESCRIPTION

DATE

DWN

APVD

SEE SHEET 1.

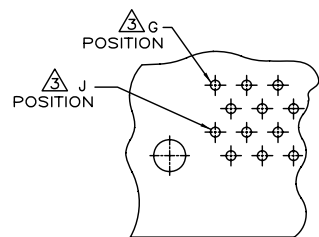

FOR 50, 60, AND 130 POSITIONS ONLY

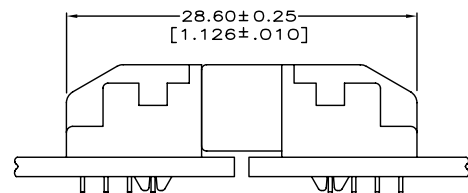
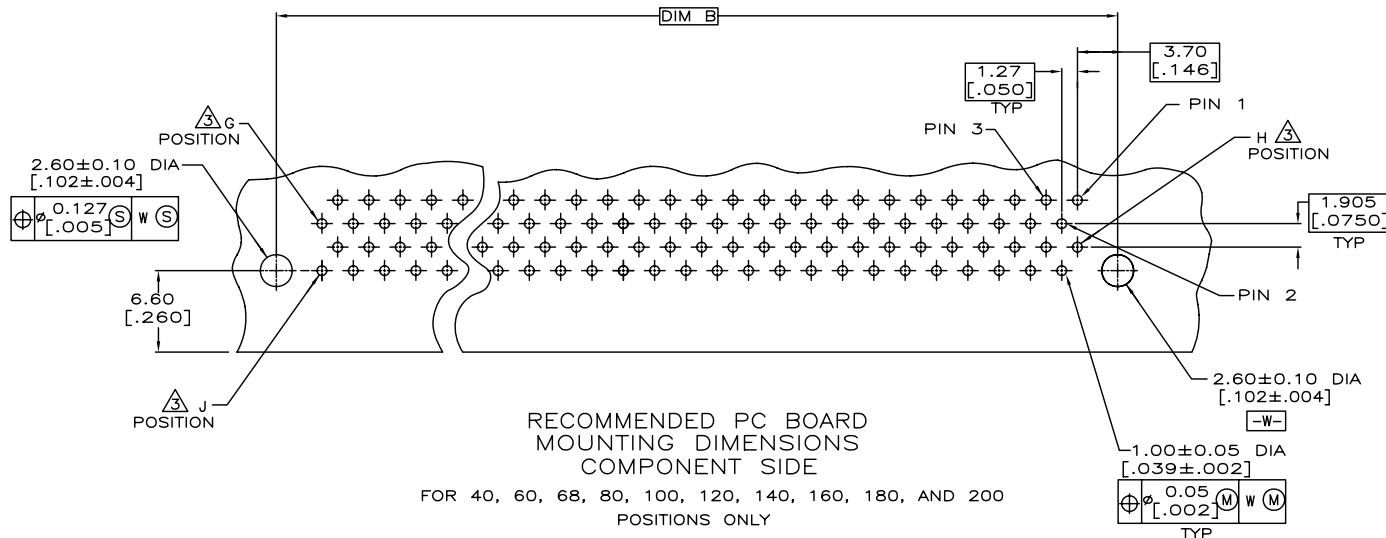

RIGHT ANGLE RECEPTACLE ASSEMBLY MATED TO RIGHT ANGLE PLUG ASSEMBLY

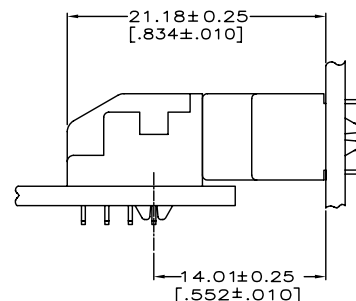

RIGHT ANGLE RECEPTACLE ASSEMBLY MATED TO VERTICAL PLUG ASSEMBLY

THIS DRAWING IS A CONTROLLED DOCUMENT.		DWN		Tyco Electronics Corporation Taipei, Taiwan	
DIMENSIONS: MM		CHK		NAME	
TOLERANCES UNLESS OTHERWISE SPECIFIED:		APVD		PLUG ASSEMBLY, RIGHT ANGLE, 13.2 mm, BOARD-TO-BOARD, CHAMP .050, SERIES I	
0 PLC ± -		PRODUCT SPEC		SIZE	
1 PLC ± -		APPLICATION SPEC		CAGE CODE	
2 PLC ± -		WEIGHT		DRAWING NO	
3 PLC ± -		CUSTOMER DRAWING		RESTRICTED TO	
4 PLC ± -		SCALE		A3 00779 C=1734099	
ANGLES ± -		SHEET		2 of 4	
FINISH		REV		C1	

THIS DRAWING IS UNPUBLISHED.

RELEASED FOR PUBLICATION

AUG ,2006.

© COPYRIGHT BY TYCO ELECTRONICS CORPORATION. ALL RIGHTS RESERVED.

LOC

DIST

REVISIONS

DW

P

LTR

DESCRIPTION

DATE

DWN

APVD

SEE SHEET 1.

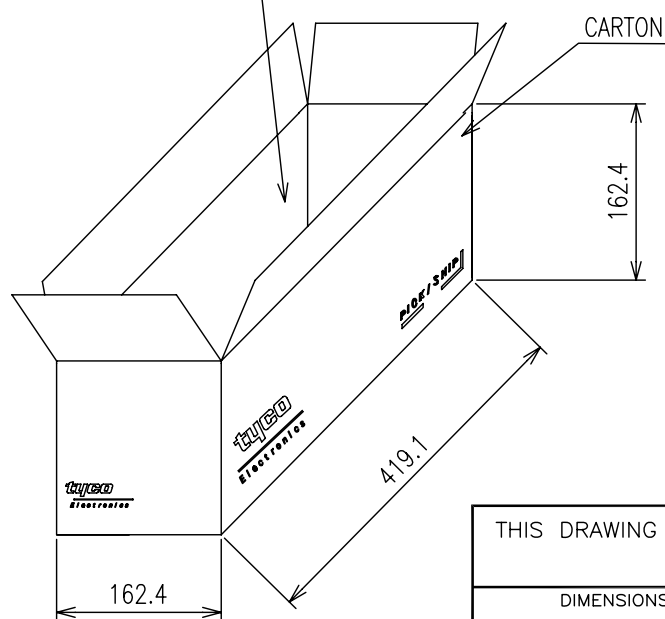
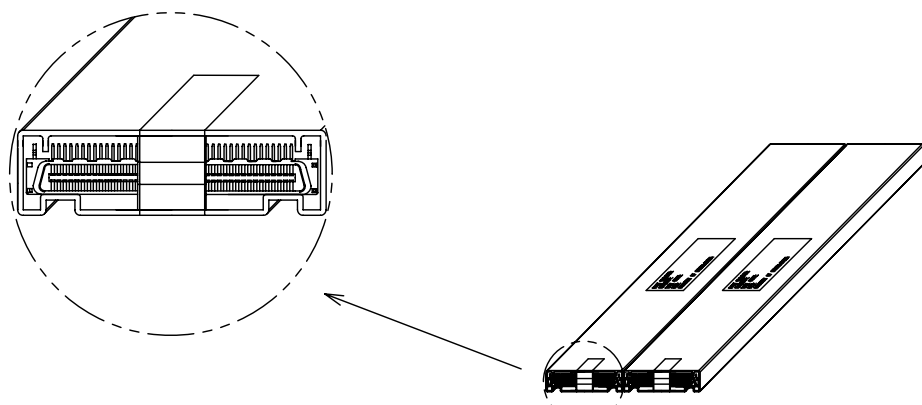
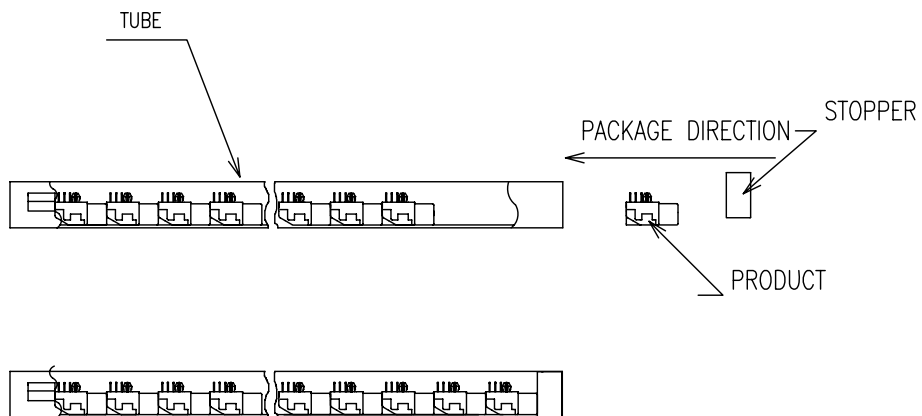

POS.	QTY/TUBE	TUBE/CARTON	QTY/CARTON	N.W./CARTON	G.W./CARTON	PART NUMBER
100	21	16	336	2.60KG	3.44KG	1-1734099-0
80	21	16	336	2.15KG	3.00KG	1734099-8

THIS DRAWING IS A CONTROLLED DOCUMENT.		DWN
DIMENSIONS: MM		CHK
TOLERANCES UNLESS OTHERWISE SPECIFIED:		APVD
0 PLC	± -	PRODUCT SPEC
1 PLC	± -	—
2 PLC	± -	APPLICATION SPEC
3 PLC	± -	—
4 PLC	± -	WEIGHT
ANGLES	± -	—
MATERIAL	FINISH	CUSTOMER DRAWING

Tyco Electronics Corporation Taipei, Taiwan			
NAME			
PLUG ASSEMBLY, RIGHT ANGLE, 13.2 mm, BOARD-TO-BOARD, CHAMP .050, SERIES I			
SIZE	CAGE CODE	DRAWING NO	RESTRICTED TO
A3	00779	1734099	—
SCALE		SHEET	REV
—		3 of 4	C1

4

3

2

1

THIS DRAWING IS UNPUBLISHED. RELEASED FOR PUBLICATION AUG ,2006.  
 © COPYRIGHT BY TYCO ELECTRONICS CORPORATION. ALL RIGHTS RESERVED.

LOC	DIST	REVISIONS					
DW		P	LTR	DESCRIPTION	DATE	DWN	APVD
				SEE SHEET 1.			

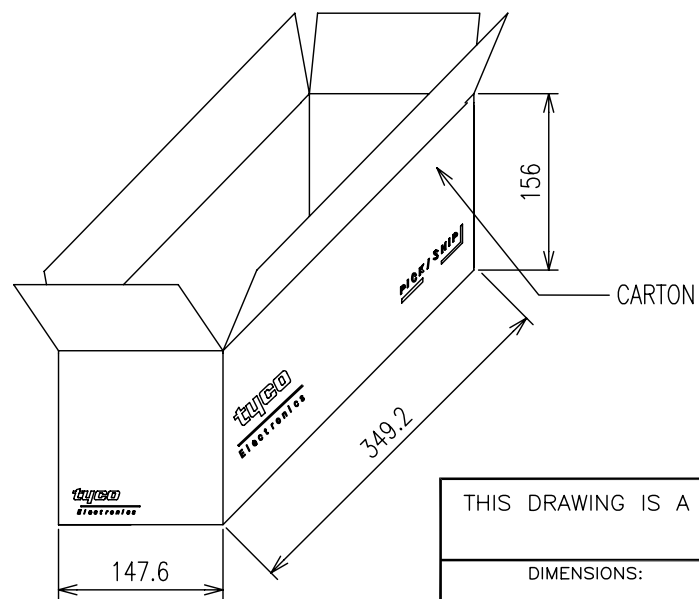
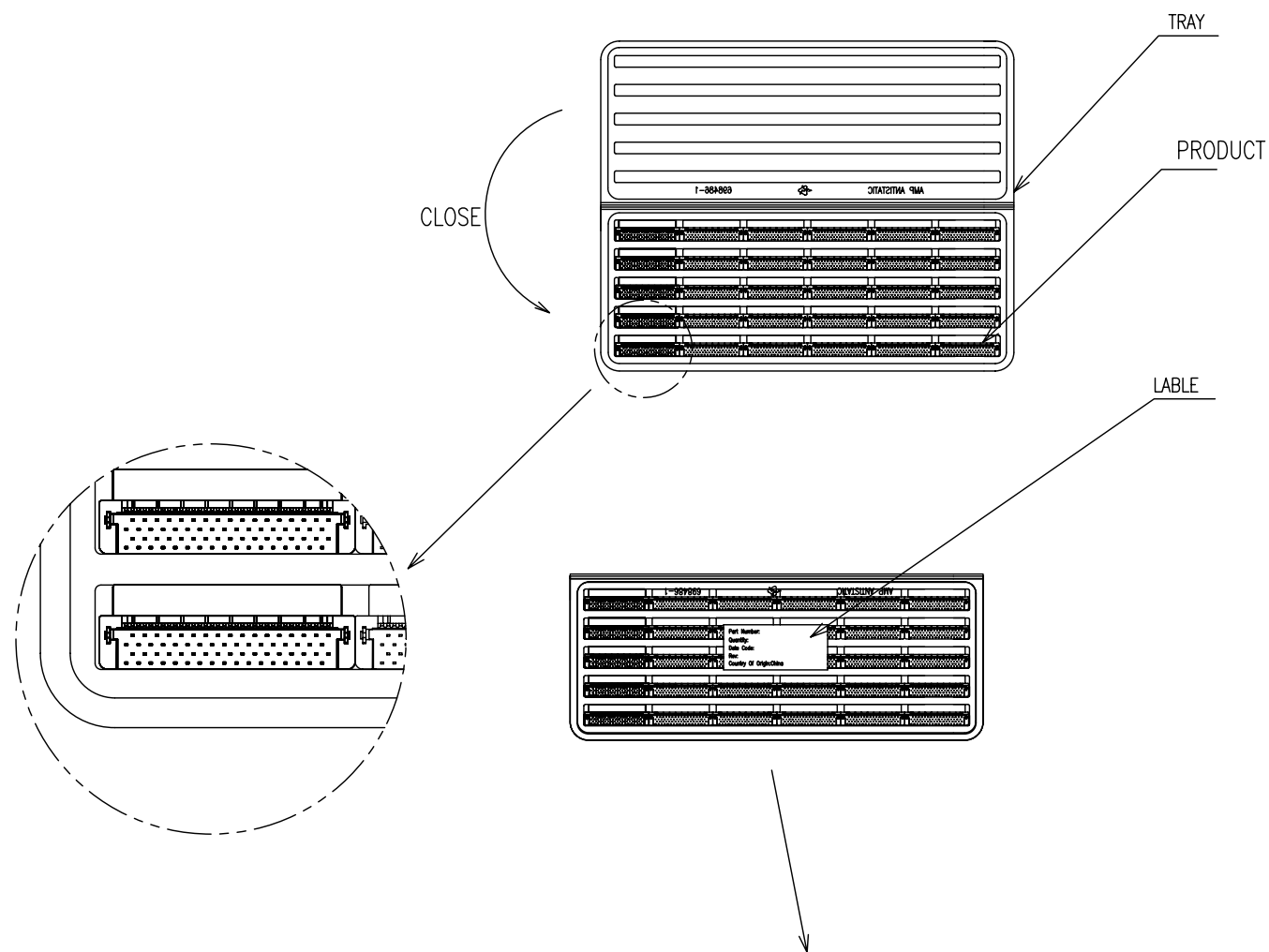

POS.	QTY/TRAY	TRAY/CARTON	QTY/CARTON	N.W./CARTON	G.W./CARTON	PART NUMBER
200	10	10	100	1.40KG	2.35KG	1-1734099-8
160	10	10	100	1.18KG	2.13KG	1-1734099-6
140	15	10	150	1.59KG	2.46KG	1-1734099-4
120	15	10	150	1.20KG	2.15KG	1-1734099-2
68	30	10	300	1.69KG	2.64KG	1734099-7
60	30	10	300	1.53KG	2.48KG	1734099-6
50	35	10	350	1.58KG	2.56KG	1734099-5
40	45	10	450	1.71KG	2.66KG	1734099-4

THIS DRAWING IS A CONTROLLED DOCUMENT.		DWN		Tyco Electronics Corporation Taipei, Taiwan	
DIMENSIONS: MM		TOLERANCES UNLESS OTHERWISE SPECIFIED:		NAME	
		0 PLC ± - 1 PLC ± - 2 PLC ± - 3 PLC ± - 4 PLC ± - ANGLES ± -		PLUG ASSEMBLY, RIGHT ANGLE, 13.2 mm, BOARD-TO-BOARD, CHAMP .050, SERIES I	
MATERIAL		FINISH		SIZE CAGE CODE DRAWING NO RESTRICTED TO	
				A3 00779 C-1734099	
				SCALE SHEET 4 of 4 REV C1	
CUSTOMER DRAWING					